

MBRF10150LCT-HAF

Schottky Barrier Rectifier

Features

- Halogen and Antimony Free(HAF),
RoHS compliant

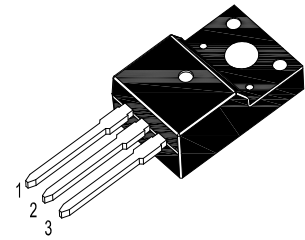
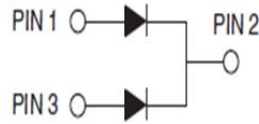

1.Anode 2.Cathode 3.Anode
TO-220F Plastic Package

Absolute Maximum Ratings (T_a = 25°C)

Parameter	Symbol	Value	Unit
Maximum Recurrent Peak Reverse Voltage	V _{RRM}	150	V
Reverse Stand-Off Voltage	V _{RWM}	150	V
DC Blocking Voltage	V _R	150	V
RMS Reverse Voltage	V _{RMS}	105	V
Average Rectified Forward Current at T _a = 125°C	I _{F(AV)}	5 10	A
Nonrepetitive Peak Surge Current (8.3 ms)	I _{FSM}	125	A
Operating Junction and Storage Temperature Range	T _J , T _{stg}	- 65 to + 175	°C

Thermal Characteristics

Parameter	Symbol	Value	Unit
Typical Thermal Resistance from Junction to Case	R _{θJC}	4	°C/W

Characteristics at T_a = 25°C unless otherwise specified

Parameter	Symbol	Min.	Typ.	Max.	Unit
Reverse Breakdown Voltage at I _R = 50 μA	V _{(BR)R}	150	-	-	V
Forward Voltage at I _F = 5 A at I _F = 5 A, T _j = 125°C	V _F	- -	- 0.67	0.95 -	V
Reverse Current at V _R = 150 V at V _R = 150 V, T _j = 125°C	I _R	- -	- 0.5	10 -	μA mA

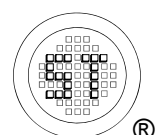

MBRF10150LCT-HAF

Electrical Characteristic Curves

Fig 1. Reverse Characteristic Curve

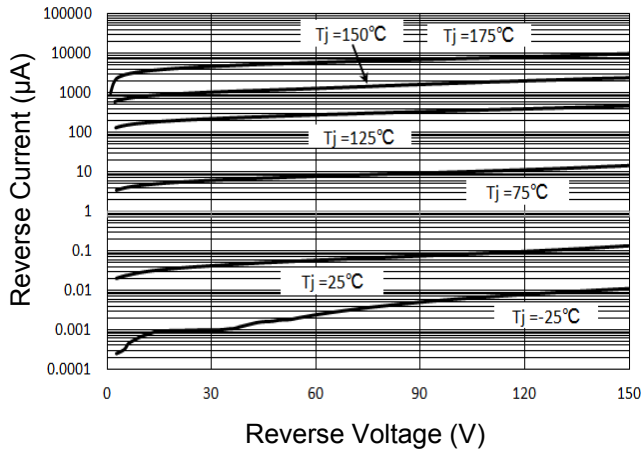

Fig 2. Forward Characteristic Curve

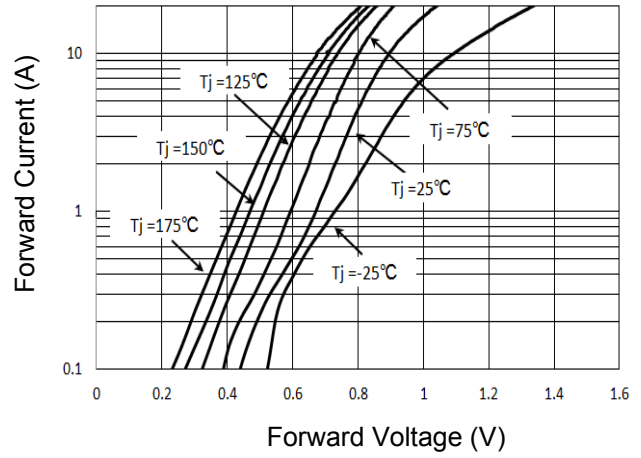

Fig 3. Junction Capacitance

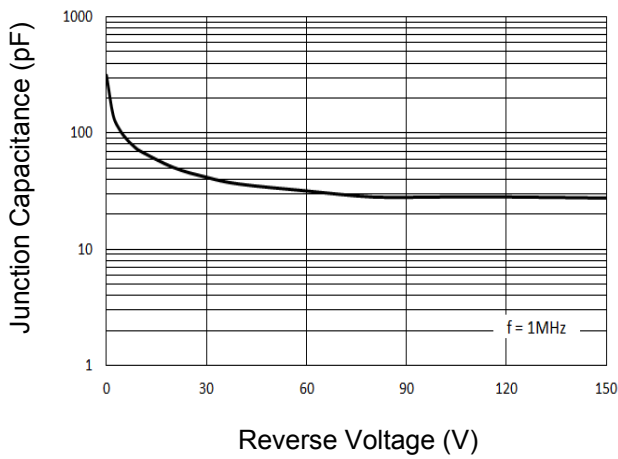

Fig 4. Thermal Resistance Curve

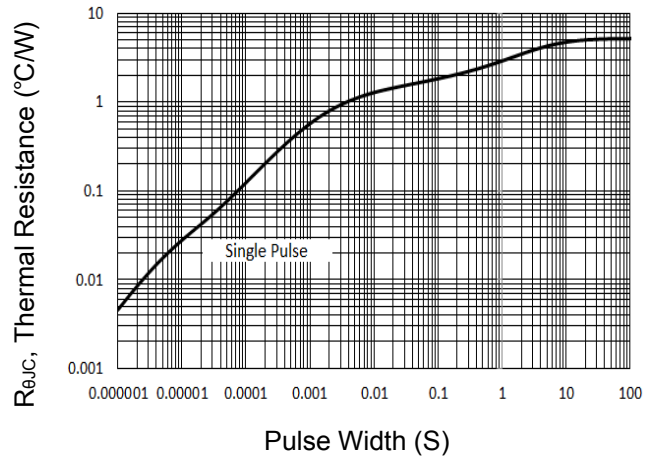
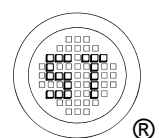
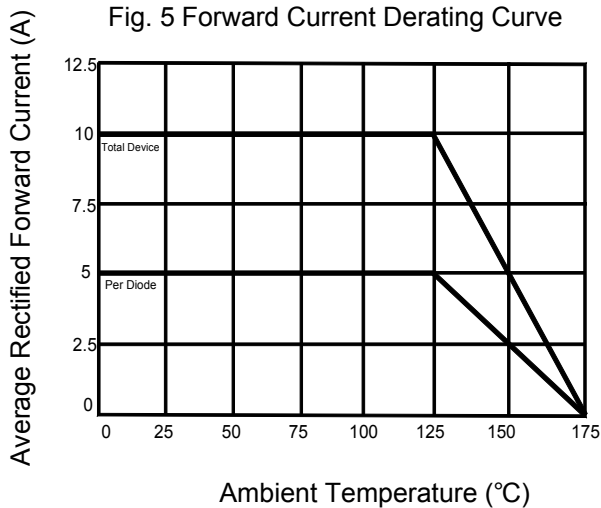

Fig. 5 Forward Current Derating Curve



MBRF10150LCT-HAF

Package Outline Dimensions (Units: mm)

TO-220F

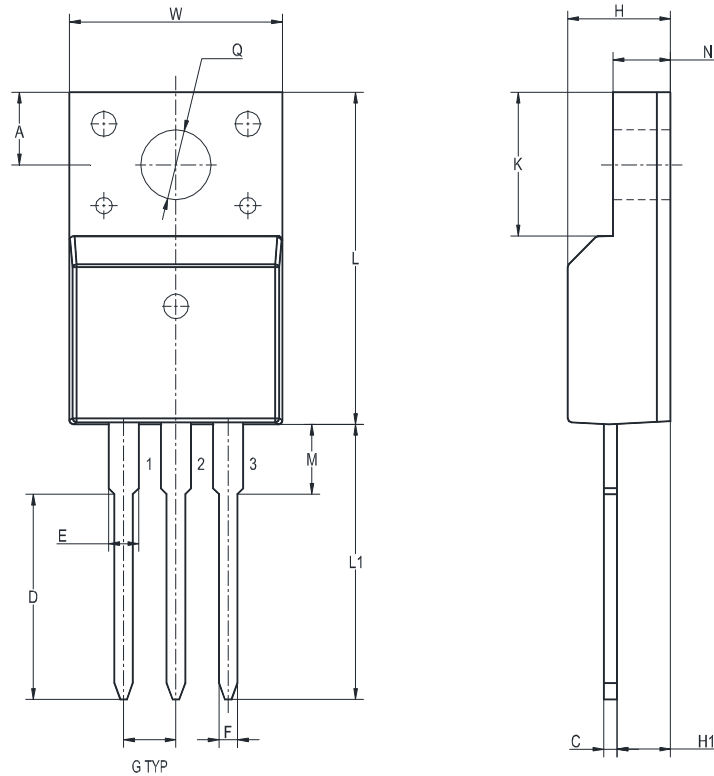

UNIT	A	C	D	E	F	G	W	H	H1	Q	L	L1	M	K	N
mm	3.5	0.7	10.3	1.5	0.9	2.54	10.5	4.9	2.9	3.4	16	13.5	3.5	6.7	2.8
	2.8	0.4	9.7	1.1	0.7	TYP.	9.5	4.5	2.5	2.9	15	12.5	2.9	6.2	2.3

Packing information

Package	Carton Quantity	Box Quantity	Base Quantity	Delivery Mode
TO-220F	5 K / Carton	1 K / Box	50 pcs / Tube	Tube

Marking information

" MBRF10150LCT " = Part No.

" ***** " = Date Code Marking

Font type: Arial

