

# FWS01H60S

**Super Fast Recovery Rectifier**  
**Reverse Voltage - 600 V**  
**Forward Current - 0.2 A**

## Features

- Low power loss, high efficiency
- High frequency rectification
- Standard fast recovery
- Silicon epitaxial planar type

## PINNING

PIN	DESCRIPTION
1	Cathode
2	Anode

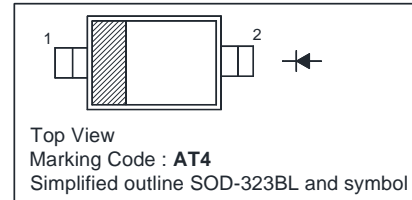

## Maximum Ratings and Characteristics

Ratings at 25°C ambient temperature unless otherwise specified.

Parameter	Symbols	Value	Units
Maximum Recurrent Peak Reverse Voltage	$V_{RRM}$	600	V
Maximum DC Blocking Voltage	$V_{DC}$	600	V
Maximum Average Forward Rectified Current	$I_{F(AV)}$	0.2	A
Power Dissipation	$P_D$	250	mW
Peak Forward Surge Current 8.3 ms Single Half Sine Wave Superimposed on Rated Load(JEDEC method)	$I_{FSM}$	1	A
Maximum Forward Voltage at $I_F = 0.2$ A	$V_F$	2.2	V
Maximum DC Reverse Current at Rated DC Blocking Voltage	$I_R$	10	$\mu$ A
Maximum Reverse Recovery Time <sup>1)</sup>	$T_{rr}$	35	ns
Maximum Reverse Recovery Time <sup>2)</sup>	$T_{rr}$	25	ns
Typical Junction Capacitance at $V_R = 0V, f = 1MHz$	$C_J$	5	pF
Operating and Storage Temperature Range	$T_j, T_{stg}$	- 55 to + 150	°C

<sup>1)</sup> Reverse Recovery Test Conditions :  $I_F = 0.1$  A ,  $I_R = 0.1$  A ,  $I_{rr} = 0.1 \cdot I_R$  .

<sup>2)</sup> Reverse Recovery Test Conditions :  $I_F = 0.1$  A ,  $I_R = 0.2$  A ,  $I_{rr} = 0.1 \cdot I_R$  .

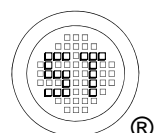

# FWS01H60S

## Electrical Characteristics Curves

Fig.1 Forward Current Derating Curve

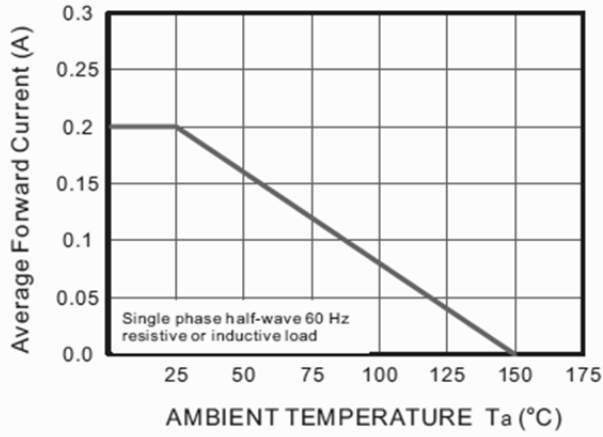

Fig.2 Typical Reverse Characteristics

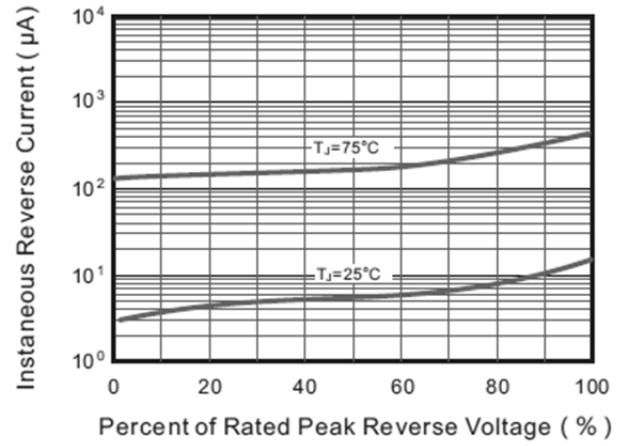

Fig.3 TYPICAL FORWARD VOLTAGE

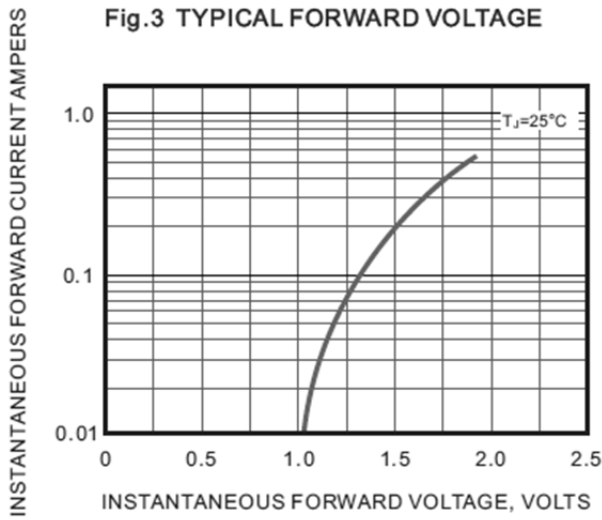
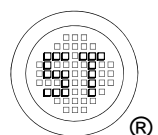
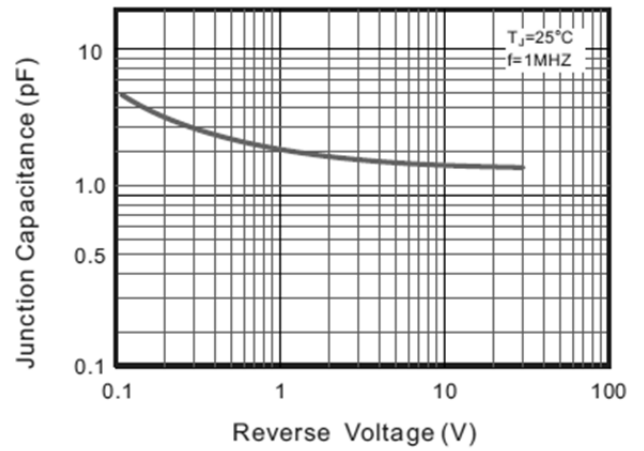

Fig.4 Typical Junction Capacitance



# FWS01H60S

## PACKAGE OUTLINE

Plastic surface mounted package; 2 leads

SOD-323BL

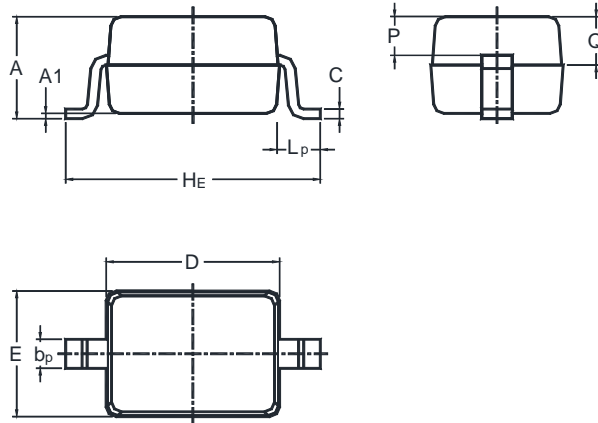

UNIT	A	A <sub>1</sub>	b <sub>p</sub>	C	D	E	H <sub>ε</sub>	L <sub>p</sub>	Q	P
mm	1.1 0.8	0.1 0	0.4 0.25	0.18 0.09	1.8 1.6	1.35 1.15	2.8 2.3	0.5 0.1	0.5 0.3	0.4 0.3

### Recommended Soldering Footprint

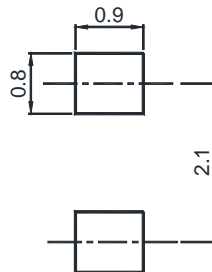

### Packing information

Package	Tape Width (mm)	Pitch		Reel Size		Per Reel Packing Quantity
		mm	inch	mm	inch	
SOD-323BL	8	4 ± 0.1	0.157 ± 0.004	178	7	3,000

### Marking information

" I " = Cathode line

" AT4 " = Part No.

Font type: Arial

