

ESDU2271GP

ESD Protection Diode

Features

- Low leakage current

PINNING

PIN	DESCRIPTION
1	Cathode
2	Anode

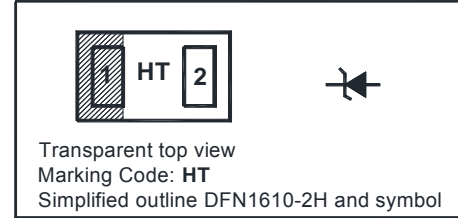

Absolute Maximum Ratings ($T_a = 25^\circ\text{C}$)

Parameter	Symbol	Value	Unit
Peak Pulse Power ($t_p = 8/20 \mu\text{s}$)	P_{PK}	1375	W
Peak Pulse Current ($t_p = 8/20 \mu\text{s}$)	I_{PP}	25	A
IEC61000-4-2 (ESD) Air Contact	V_{ESD}	± 30 ± 30	KV
Operation Temperature Range	T_j	- 40 to + 125	$^\circ\text{C}$
Storage Temperature Range	T_{stg}	- 55 to + 150	$^\circ\text{C}$

Characteristics at $T_a = 25^\circ\text{C}$

Parameter	Symbol	Min.	Typ.	Max.	Unit
Reverse Stand-Off Voltage	V_{RWM}	-	-	22	V
Reverse Breakdown Voltage at $I_R = 1 \text{ mA}$	$V_{(BR)R}$	25.5	-	33.5	V
Reverse Current at $V_{RWM} = 22 \text{ V}$	I_R	-	-	100	nA
Clamping Voltage at $I_{PP} = 10 \text{ A}$, $t_p = 8/20 \mu\text{s}$ at $I_{PP} = 25 \text{ A}$, $t_p = 8/20 \mu\text{s}$	V_C	-	-	40 55	V
ESD Clamping Voltage at $I_{TLP} = 4 \text{ A}$, $t_p = 0.2/100 \text{ ns}$ at $I_{TLP} = 16 \text{ A}$, $t_p = 0.2/100 \text{ ns}$	V_{CL}	-	30.5 32	-	V
Junction Capacitance at $V_R = 0 \text{ V}$, $f = 1 \text{ MHz}$	C_j	-	-	220	pF
Dynamic Resistance ¹⁾	R_{dyn}	-	0.13	-	Ω

¹⁾ Dynamic Resistance calculated from $I_{TLP} = 4 \text{ A}$ to $I_{TLP} = 16 \text{ A}$.

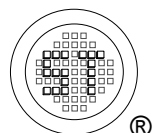

Electrical characteristic curves

Fig 1. Pulse Waveform

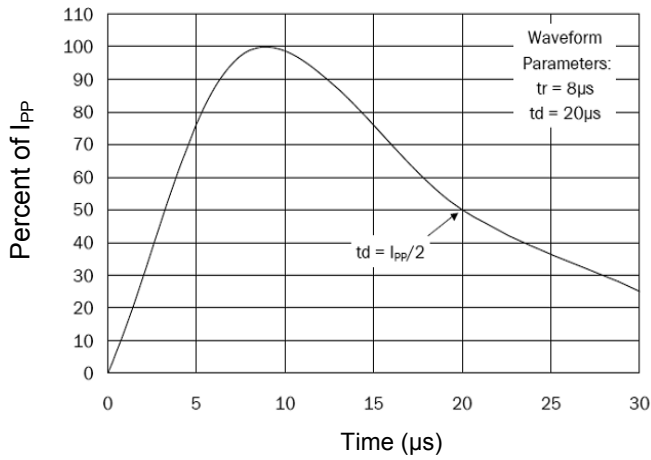

Fig 2. Power Derating Curve

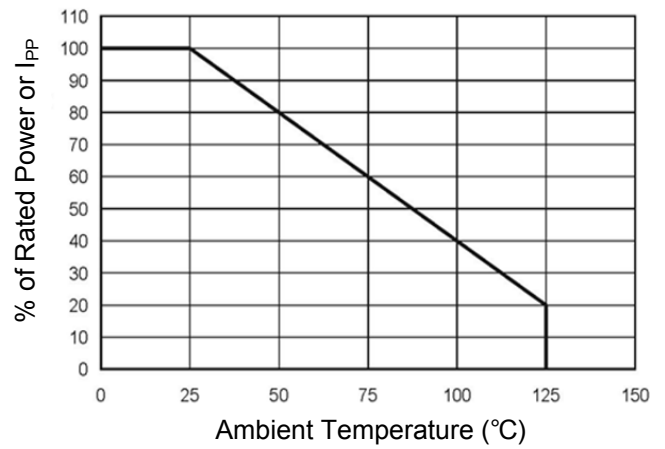

Fig 3. Clamping Voltage Curve

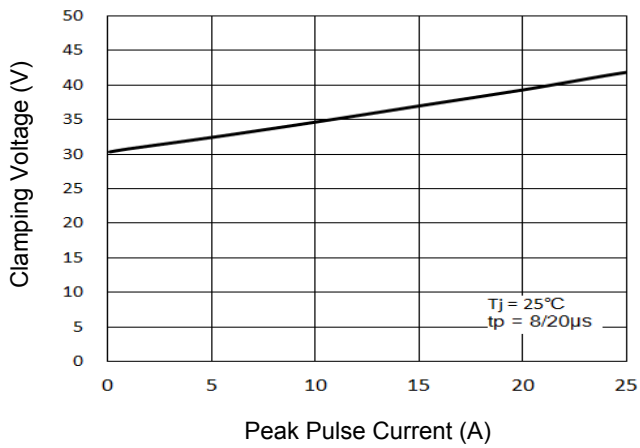

Fig 4. Junction Capacitance

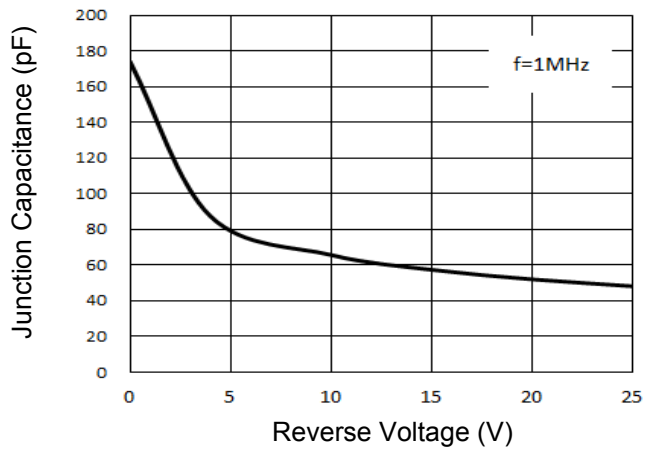
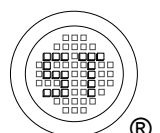
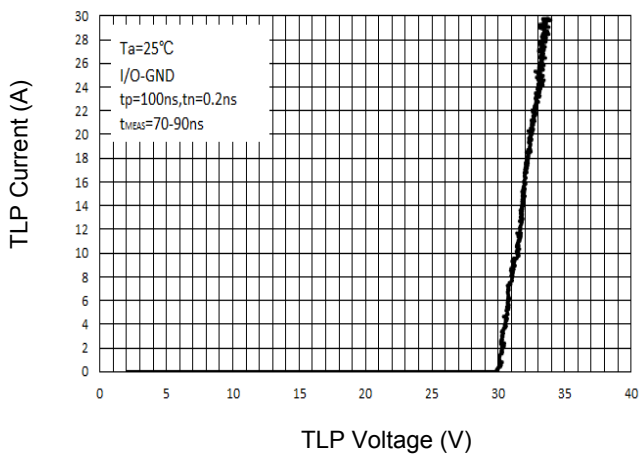

Fig 5. TLP Curve



ESDU2271GP

PACKAGE OUTLINE

Plastic surface mounted package

DFN1610-2H

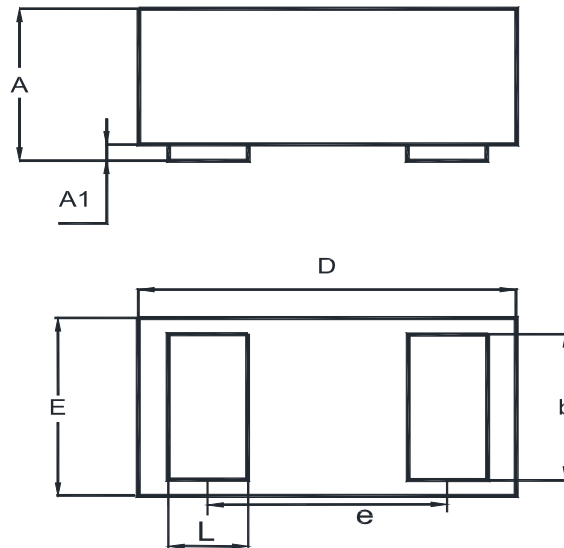

UNIT	A	A1	b	D	E	e	L
mm	0.55	0.05	0.95	1.65	1.05	1.1	0.45
	0.45	0	0.85	1.55	0.95		0.35

Recommended Soldering Footprint

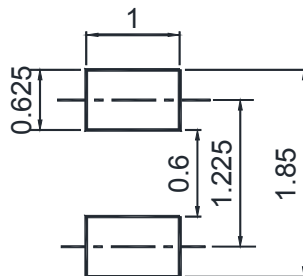

Packing information

Package	Tape Width (mm)	Pitch		Reel Size		Per Reel Packing Quantity
		mm	inch	mm	inch	
DFN1610-2H	8	2 ± 0.1	0.079 ± 0.004	178	7	10,000

Marking information

" HT " = Part No.

Font type: Arial

