

ESD5BL5V0

ESD Protection Diode

Features

- Bi-directional low capacitance

PINNING

PIN	DESCRIPTION
1	Anode
2	Anode

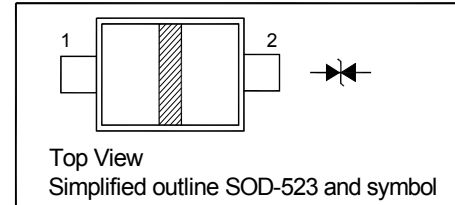

Absolute Maximum Ratings (at $T_a = 25^\circ\text{C}$ unless otherwise specified)

Parameter	Symbol	Value	Unit
Peak Pulse Power Dissipation ($t_p = 8/20 \mu\text{s}$)	P_{PP}	84	W
Peak Pulse Current ($t_p = 8/20 \mu\text{s}$)	I_{PP}	6	A
ESD Discharge (IEC61000-4-2) Air Contact	V_{ESD}	± 30 ± 30	KV
ESD Voltage Per Human Body Model Per Machine Model	V_{ESD}	30 500	KV V
Power Dissipation ¹⁾	P_D	150	mW
Operating Junction Temperature	T_j	150	$^\circ\text{C}$
Storage Temperature Range	T_{stg}	- 55 to + 150	$^\circ\text{C}$

¹⁾ Device mounted on FR-4 PCB pad layout (2 oz copper)

Characteristics at $T_a = 25^\circ\text{C}$ unless otherwise specified

Parameter	Symbol	Min.	Typ.	Max.	Unit
Reverse Standoff Voltage	V_{RWM}	-	-	5	V
Breakdown Voltage at $I_R = 1 \text{ mA}$	V_{BR}	6	-	8	V
Reverse Current at $V_R = 5 \text{ V}$	I_R	-	-	100	nA
Clamping Voltage at $I_{PP} = 1 \text{ A}$, $t_p = 8/20 \mu\text{s}$ at $I_{PP} = 3 \text{ A}$, $t_p = 8/20 \mu\text{s}$ at $I_{PP} = 5 \text{ A}$, $t_p = 8/20 \mu\text{s}$ at $I_{PP} = 6 \text{ A}$, $t_p = 8/20 \mu\text{s}$	V_C	-	-	9 10.7 13.5 14	V
ESD Clamping Voltage at $I_{TLP} = 4 \text{ A}$, $t_p = 100 \text{ ns}$, $t_n = 0.2 \text{ ns}$ at $I_{TLP} = 16 \text{ A}$, $t_p = 100 \text{ ns}$, $t_n = 0.2 \text{ ns}$	V_{CL}	-	7.9 10.9	-	V
Diode Capacitance at $V_R = 0 \text{ V}$, $f = 1 \text{ MHz}$	C_D	-	-	20	pF
Dynamic Resistance ¹⁾	R_{DYN}	-	0.25	-	Ω

¹⁾ Dynamic Resistance calculated from $I_{TLP} = 4 \text{ A}$ to $I_{TLP} = 16 \text{ A}$.

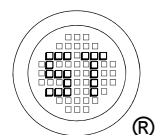

ESD5BL5V0

Electrical Characteristics Curves

Fig 1. Pulse Waveform

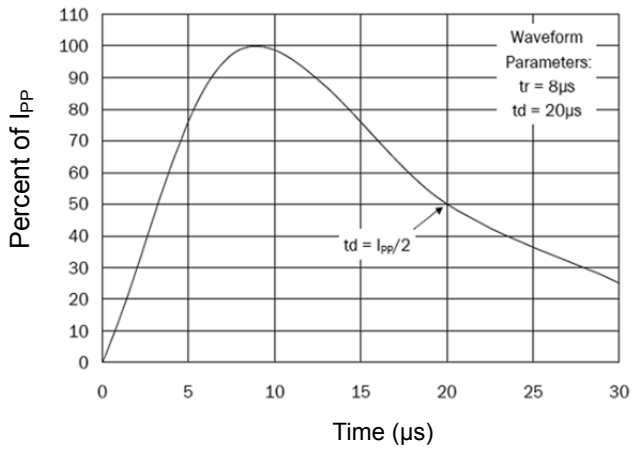

Fig 2. Power Derating Curve

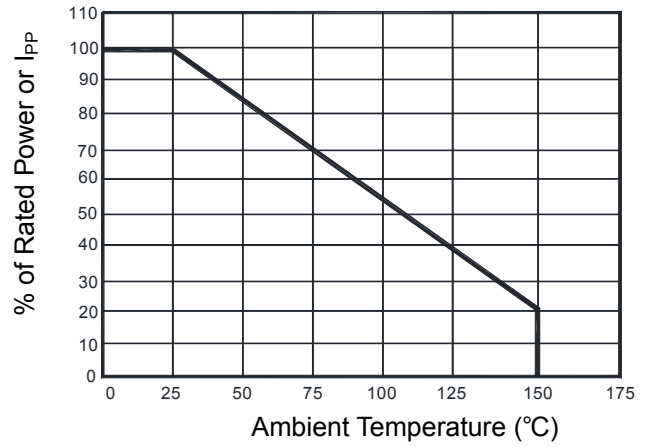

Fig 3. Clamping Voltage Curve

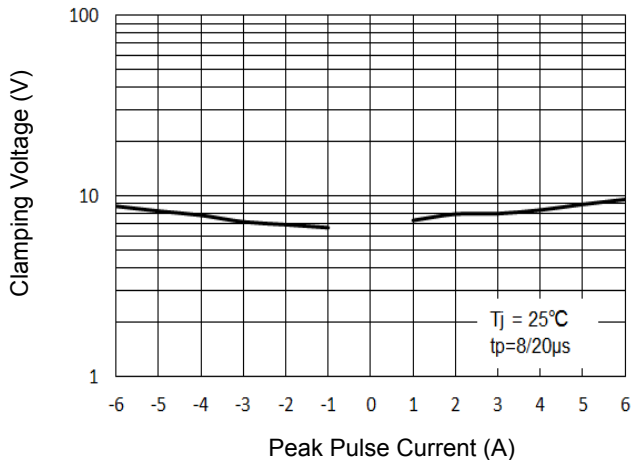

Fig 4. Junction Capacitance

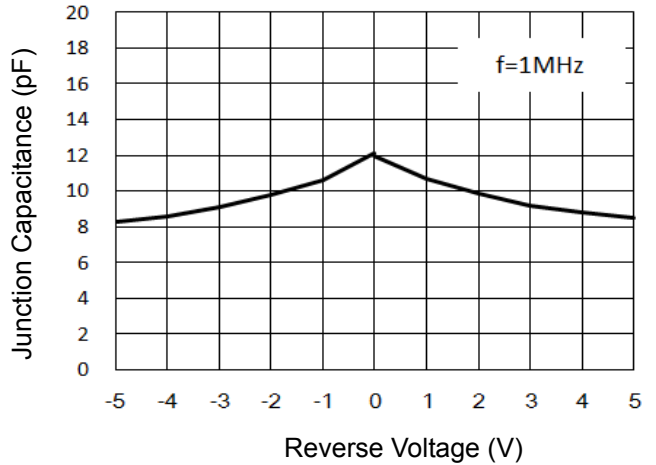
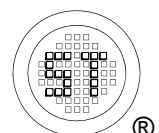
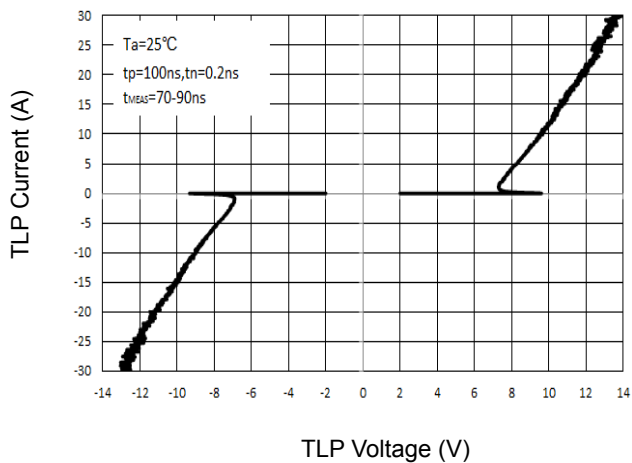

Fig 5. TLP Curve



ESD5BL5V0

PACKAGE OUTLINE

Plastic surface mounted package; 2 leads

SOD-523

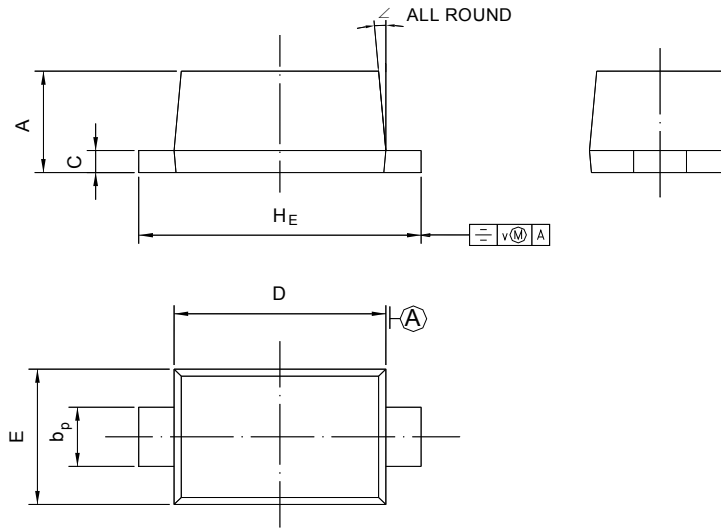

UNIT	A	b _p	C	D	E	H _E	V	∠
mm	0.70 0.60	0.4 0.3	0.135 0.100	1.25 1.15	0.85 0.75	1.7 1.5	0.1	5°

Recommended Soldering Footprint

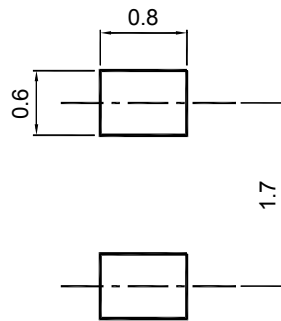

Packing information

Package	Tape Width (mm)	Pitch		Reel Size		Per Reel Packing Quantity
		mm	inch	mm	inch	
SOD-523	8	4 ± 0.1	0.157 ± 0.004	178	7	4,000

Marking information

" III ": Polarity marking

