

BAS316WT

Silicon Epitaxial Planar Switching Diode

PIN	DESCRIPTION
1	Cathode
2	Anode

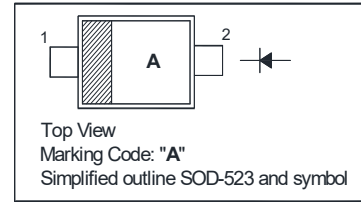

Absolute Maximum Ratings ($T_a = 25\text{ }^\circ\text{C}$)

Parameter	Symbol	Value	Unit
Repetitive Peak Reverse Voltage	V_{RRM}	100	V
Reverse Voltage	V_R	100	V
Continuous Forward Current	I_F	250	mA
Repetitive Peak Forward Current	I_{FRM}	500	mA
Non-Repetitive Peak Forward Current	I_{FSM}	$t = 1\ \mu\text{s}$ 4	A
		$t = 1\ \text{ms}$ 1	
		$t = 1\ \text{s}$ 0.5	
Power Dissipation	P_D	$T_a = 25\text{ }^\circ\text{C}$ 150	mW
		$T_s \leq 90\text{ }^\circ\text{C}$ 500	
Junction Temperature	T_j	150	$^\circ\text{C}$
Storage Temperature Range	T_{stg}	- 65 to + 150	$^\circ\text{C}$

Thermal Characteristics

Parameter	Symbol	Max.	Unit
Thermal Resistance from Junction to Ambient ¹⁾	$R_{\theta JA}$	833	$^\circ\text{C/W}$

¹⁾ Device mounted on FR-4 PCB with minimum recommended pad layout.

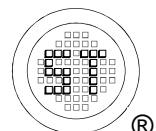

BAS316WT

Characteristics at $T_a = 25\text{ }^\circ\text{C}$

Parameter	Symbol	Max.	Unit
Forward Voltage at $I_F = 1\text{ mA}$ at $I_F = 10\text{ mA}$ at $I_F = 50\text{ mA}$ at $I_F = 150\text{ mA}$	V_F	0.715 0.855 1 1.25	V
Reverse Current at $V_R = 25\text{ V}$ at $V_R = 75\text{ V}$ at $V_R = 25\text{ V}, T_J = 150\text{ }^\circ\text{C}$ at $V_R = 75\text{ V}, T_J = 150\text{ }^\circ\text{C}$	I_R	30 1 30 50	nA μA μA μA
Diode Capacitance at $V_R = 0\text{ V}, f = 1\text{ MHz}$	C_{tot}	1.5	pF
Reverse Recovery Time at $I_F = 10\text{ mA}, V_R = 6\text{ V}, I_{\text{rr}} = 0.1 \times I_R, R_L = 100\ \Omega$	t_{rr}	4	ns

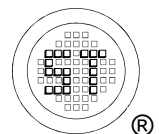

BAS316WT

Electrical Characteristics Curves

Fig 1. Power Derating Curve

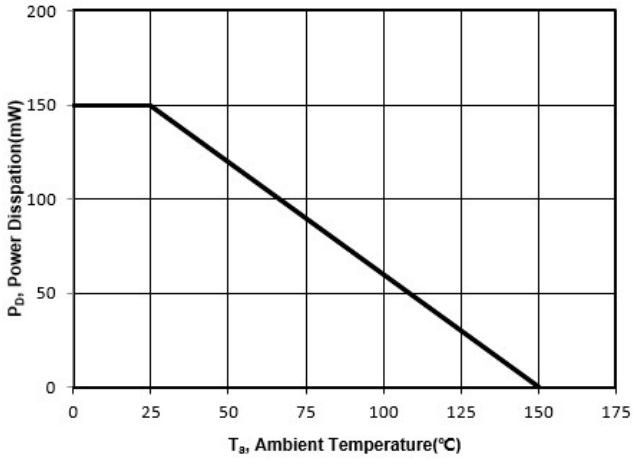

Fig 2. Total Capacitance vs. Reverse Voltage

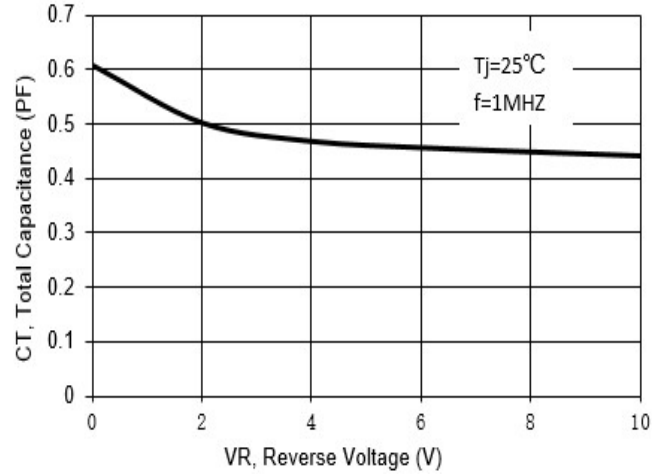

Fig 3. Reverse Current vs. Reverse Voltage

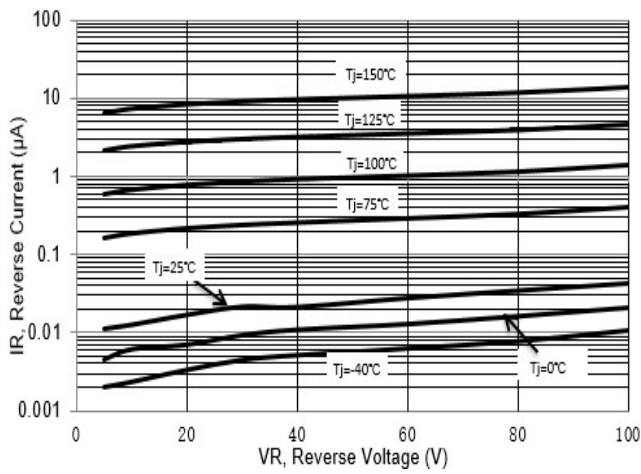
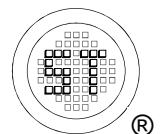
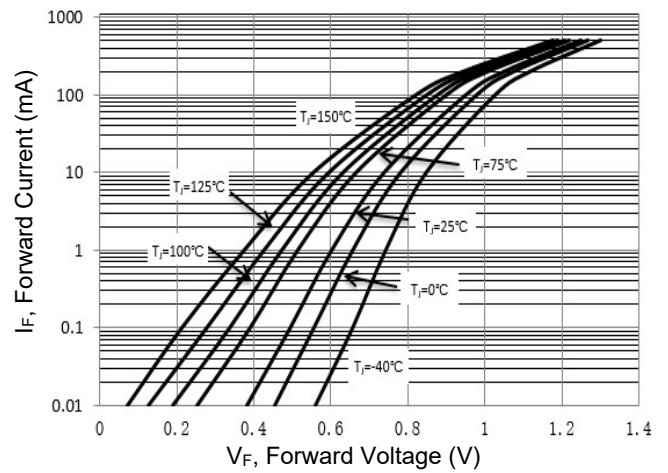

Fig 4. Forward Characteristics



BAS316WT

PACKAGE OUTLINE

Plastic surface mounted package; 2 leads

SOD-523

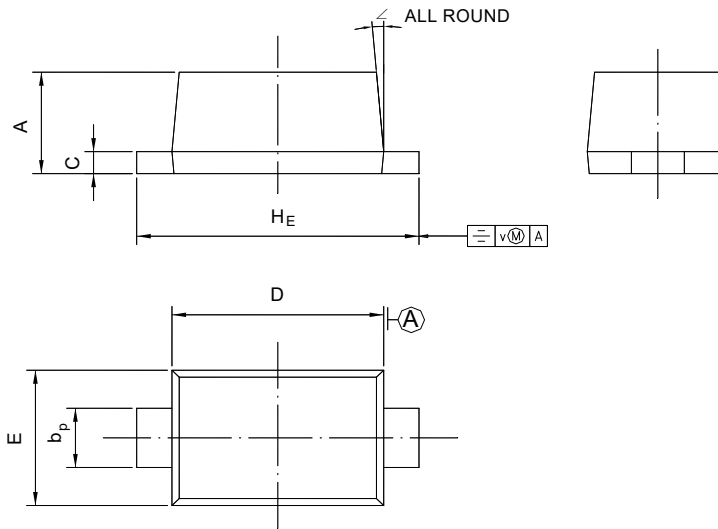

UNIT	A	b _p	C	D	E	H _E	V	∠
mm	0.70 0.60	0.4 0.3	0.135 0.100	1.25 1.15	0.85 0.75	1.7 1.5	0.1	5°

Recommended Soldering Footprint

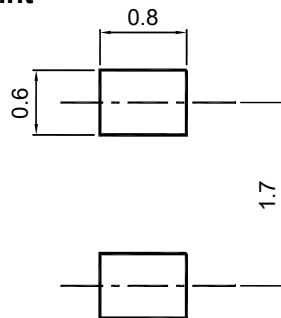

Packing information

Package	Tape Width (mm)	Pitch		Reel Size		Per Reel Packing Quantity
		mm	inch	mm	inch	
SOD-523	8	4 ± 0.1	0.157 ± 0.004	178	7	4,000

Marking information

" III " = Cathode line

" A " = Part No.

Font type: Arial

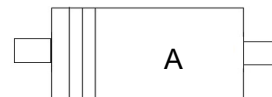

Disclaimer: Our company reserve the right to make modifications, enhancements, improvements, corrections or other changes to improve product design, functions and reliability, anytime without notice. Semtech Electronics Limited makes no warranties, representations or warranties regarding the suitability of its products for any particular purpose, and does not accept any liability arising from the application or use of any product or circuit such as: Apply to medical, military, aircraft, space or life support equipment and expressly waive any and all liability, including but not limited to special, consequential or collateral damage.

