

1SS314WT

Silicon Epitaxial Planar Band Switch Diodes

Features

- Low leakage current

Application

For VHF tuner band switch applications

PINNING

PIN	DESCRIPTION
1	Cathode
2	Anode

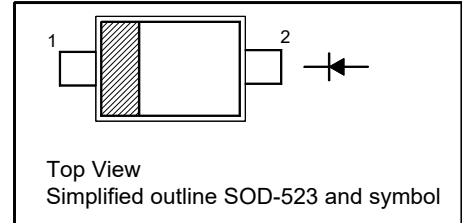

Absolute Maximum Ratings ($T_a = 25^\circ\text{C}$)

Parameter	Symbol	Value	Unit
Reverse Voltage	V_R	35	V
Forward Current	I_F	100	mA
Junction Temperature	T_J	125	$^\circ\text{C}$
Storage Temperature Range	T_{stg}	- 55 to + 125	$^\circ\text{C}$

Characteristics at $T_a = 25^\circ\text{C}$

Parameter	Symbol	Min.	Max.	Unit
Forward Voltage at $I_F = 2\text{ mA}$	V_F	-	0.85	V
Reverse Current at $V_R = 15\text{ V}$	I_R	-	100	nA
Reverse Voltage at $I_R = 1\text{ }\mu\text{A}$	V_R	35	-	V
Total Capacitance at $V_R = 6\text{ V}$, $f = 1\text{ MHz}$	C_T	-	1.2	pF
Series Resistance at $I_F = 2\text{ mA}$, $f = 100\text{ MHz}$	r_s	-	0.9	Ω

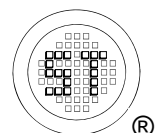

Electrical Characteristics Curves

Fig 1. r_s vs. I_F Curve

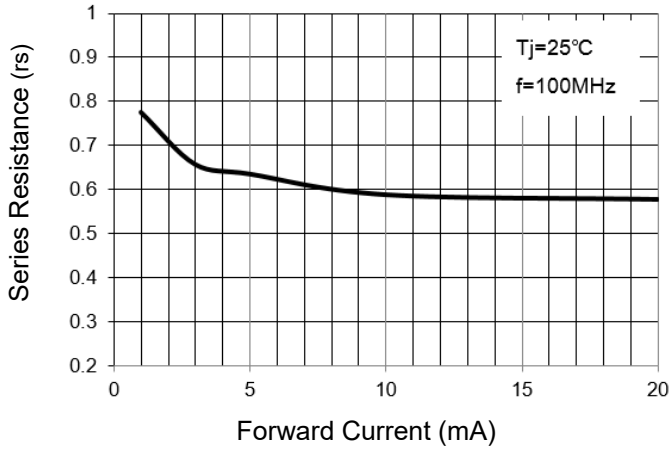

Fig 2. Forward Characteristic Curve

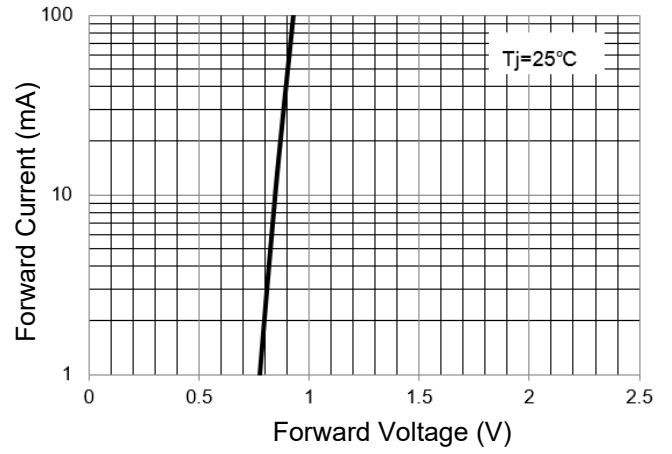

Fig 3. Junction Capacitance

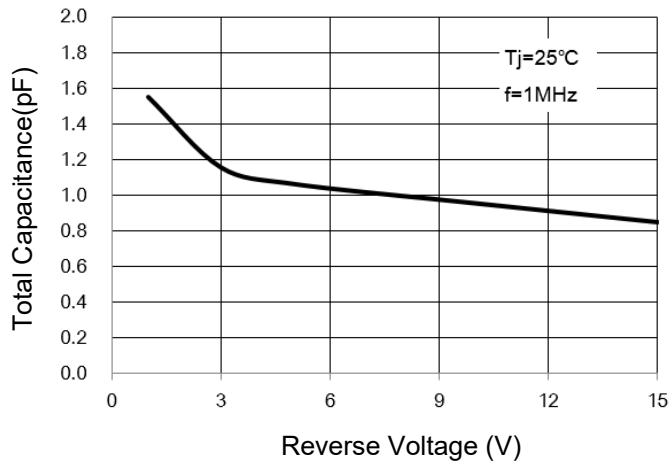
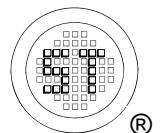
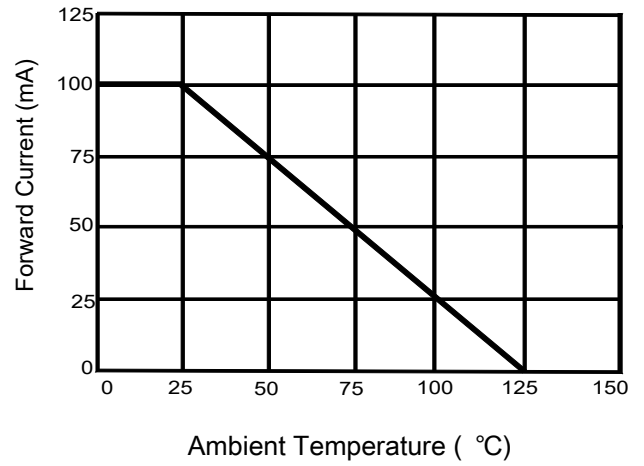

Fig 4. Forward Current Derating Curve



1SS314WT

PACKAGE OUTLINE

Plastic surface mounted package

SOD-523

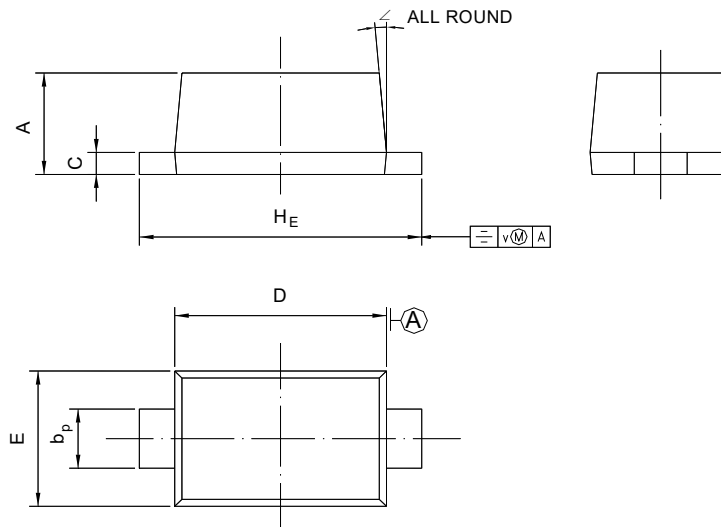

UNIT	A	b _p	C	D	E	H _E	V	∠
mm	0.70 0.60	0.4 0.3	0.135 0.100	1.25 1.15	0.85 0.75	1.7 1.5	0.1	5°

Recommended Soldering Footprint

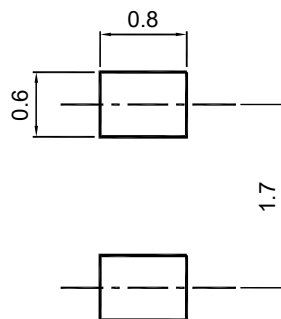

Packing information

Package	Tape Width (mm)	Pitch		Reel Size		Per Reel Packing Quantity
		mm	inch	mm	inch	
SOD-523	8	4 ± 0.1	0.157 ± 0.004	178	7	4,000

Marking information

" M " = Part No.

" III " = Cathode line

Font type: Arial

