

# 1N4148WT

## Silicon Epitaxial Planar Switching Diode

### Features

- Fast switching speed
- Ultra-small surface mount package
- For general purpose switching applications
- High conductance

### PINNING

PIN	DESCRIPTION
1	Cathode
2	Anode

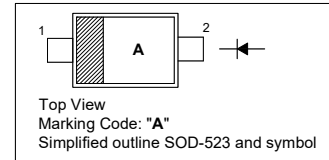

### Absolute Maximum Ratings ( $T_a = 25^\circ\text{C}$ )

Parameter	Symbol	Value	Unit
Non-Repetitive Peak Reverse Voltage	$V_{RM}$	100	V
Reverse Voltage	$V_R$	80	V
Average Rectified Forward Current	$I_{F(AV)}$	125	mA
Forward Continuous Current	$I_{FM}$	250	mA
Non-repetitive Peak Forward Surge Current	$I_{FSM}$	2 1	A
			at $t = 1 \mu\text{s}$ at $t = 100 \text{ ms}$
Power Dissipation	$P_{tot}$	150	mW
Thermal Resistance Junction to Ambient Air	$R_{\theta JA}$	833	$^\circ\text{C/W}$
Operating and Storage Temperature Range	$T_J, T_{stg}$	- 65 to + 150	$^\circ\text{C}$

### Characteristics at $T_a = 25^\circ\text{C}$

Parameter	Symbol	Min.	Max.	Unit
Reverse Breakdown Voltage at $I_R = 1 \mu\text{A}$	$V_{(BR)R}$	80	-	V
Forward Voltage at $I_F = 1 \text{ mA}$ at $I_F = 10 \text{ mA}$ at $I_F = 50 \text{ mA}$ at $I_F = 150 \text{ mA}$	$V_F$	- - - -	0.715 0.855 1 1.25	V
Peak Reverse Current at $V_R = 75 \text{ V}$ at $V_R = 20 \text{ V}$ at $V_R = 75 \text{ V}, T_J = 150^\circ\text{C}$ at $V_R = 25 \text{ V}, T_J = 150^\circ\text{C}$	$I_R$	- - - -	1 25 50 30	$\mu\text{A}$ nA $\mu\text{A}$ $\mu\text{A}$
Total Capacitance at $V_R = 0 \text{ V}, f = 1 \text{ MHz}$	$C_T$	-	2	pF
Reverse Recovery Time at $I_{rr} = 0.1 \times I_R, I_F = 10 \text{ mA}, R_L = 100 \Omega, V_R = 6 \text{ V}$	$t_{rr}$	-	4	ns

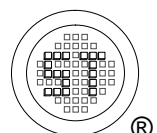

# 1N4148WT

## Electrical Characteristics Curves

Fig 1. Power Dissipation vs. Temperature

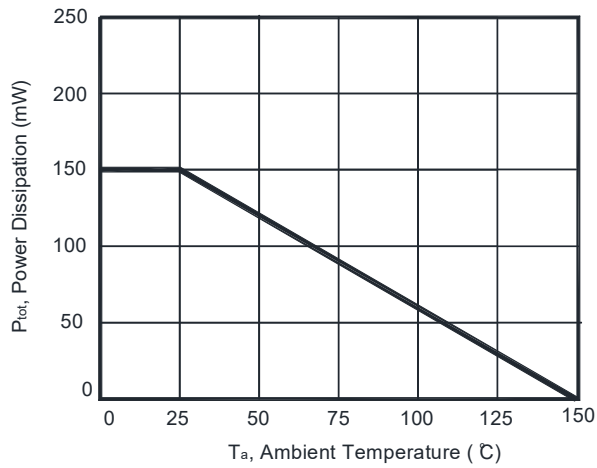

Fig 2. Total Capacitance vs. Reverse Voltage

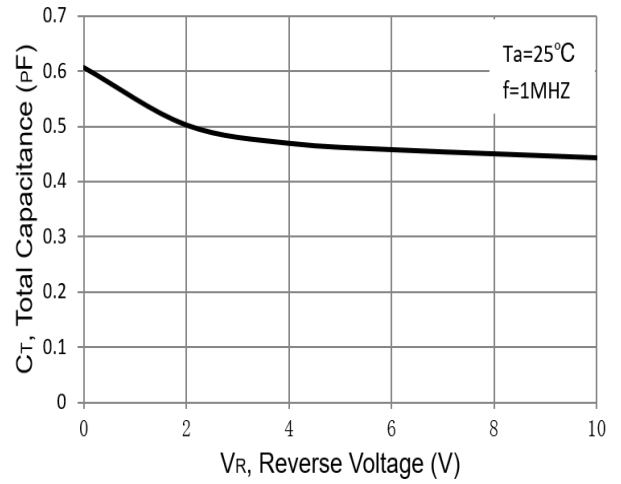

Fig 3. Reverse Current vs. Reverse Voltage

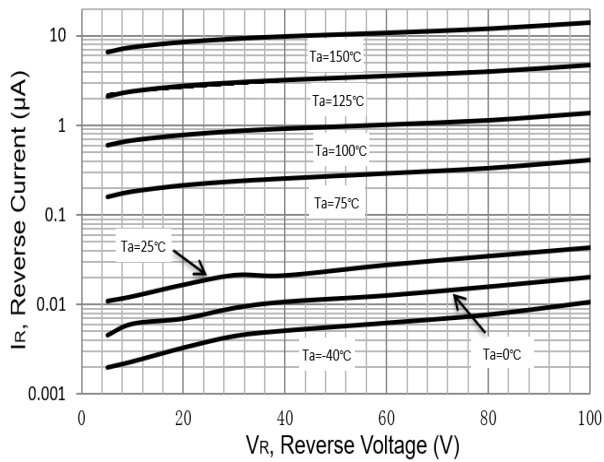
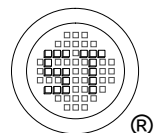
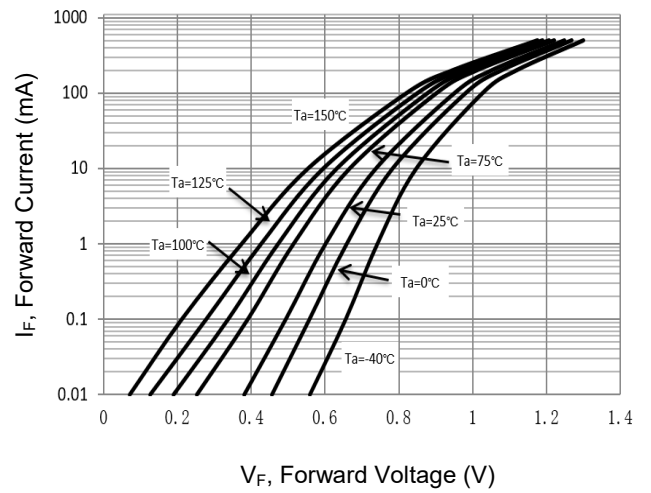

Fig 4. Forward Characteristics



# 1N4148WT

## PACKAGE OUTLINE

Plastic surface mounted package; 2 leads

SOD-523

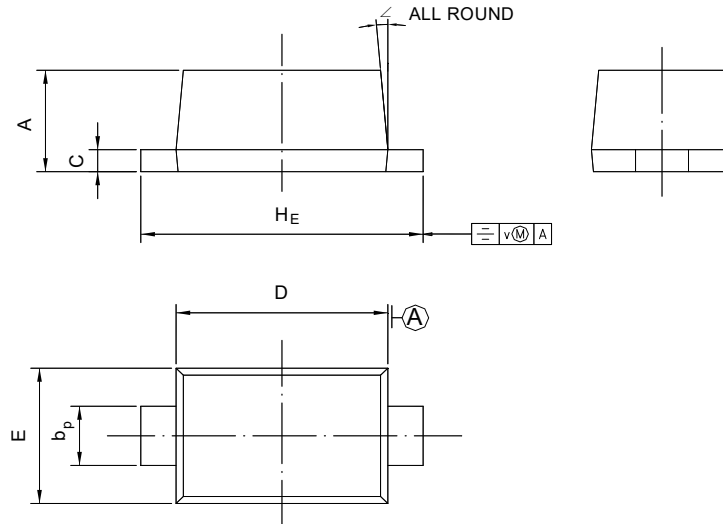

UNIT	A	$b_p$	C	D	E	$H_E$	V	$\angle$
mm	0.70 0.60	0.4 0.3	0.135 0.100	1.25 1.15	0.85 0.75	1.7 1.5	0.1	5°

### Recommended Soldering Footprint

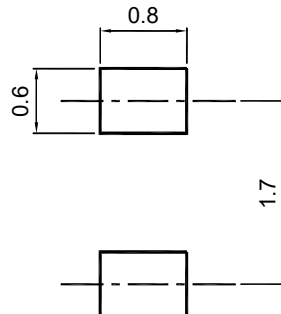

### Packing information

Package	Tape Width (mm)	Pitch		Reel Size		Per Reel Packing Quantity
		mm	inch	mm	inch	
SOD-523	8	4 ± 0.1	0.157 ± 0.004	178	7	4,000

### Marking information

" III " = Cathode line

" A " = Part No.

Font type: Arial

